

ERROR CODE	DESCRIPTION	CAUSE	REMEDY
OC1	Short-circuit	Motor/power cables short-circuit	Check power cables and motor
OC2	Discharges toward ground	One motor phase is grounded	Check power cables and motor
OH	Inverter heat sink overheat	Failed or poor inverter cooling	<ul style="list-style-type: none"> • Clean inverter cooling fan filter • Blow inverter heat sink with compressed air to clean • Check inverter cooling fans operation
OH3	Motor overheat	<ul style="list-style-type: none"> • Frequent start/stop operations • PTC failure • "Dirty" motor 	<ul style="list-style-type: none"> • Decrease the number of start/stop operations • Contact the Service Centre • Open motor case and clean the motor. Excessive dirt adversely affects motor cooling.
OH4	Inverter overheat	Failed or poor inverter cooling	<ul style="list-style-type: none"> • Clean inverter cooling fan filter • Blow inverter heat sink with compressed air to clean • Check inverter cooling fans operation
If any other error code is displayed, please take note and contact the Service Centre			

7.2 AFTER-SALES SERVICE

The Manufacturer is always willing to answer Customer's questions and give information on use, maintenance or installation and so on. Please follow the instructions given under paragraph 1.2 on how to request our assistance.

8 SPARE PARTS

8.1 SPARE PARTS LIST

Exhauster use does involve some expendable parts. Following is the list of available spare parts and expendable parts.

Table 8.1- A

POS.	DESCRIPTION	PART NO.
1	Side-channel blower	SK75-I-S-0001
2	Solenoid valve	9018
3	Pressure regulator	6709
4	Pressure gauge	K2-78
5	Silencer	SIL-6
6	Dedusting device	K5-0080
7	Filter cartridge	K5-38-C-POLY
8	Top seal	7867
9	Vacuum tube	TA-29-040
10	Vacuum tube fittings	6468+6469+M29
11	Bottom seal	7867

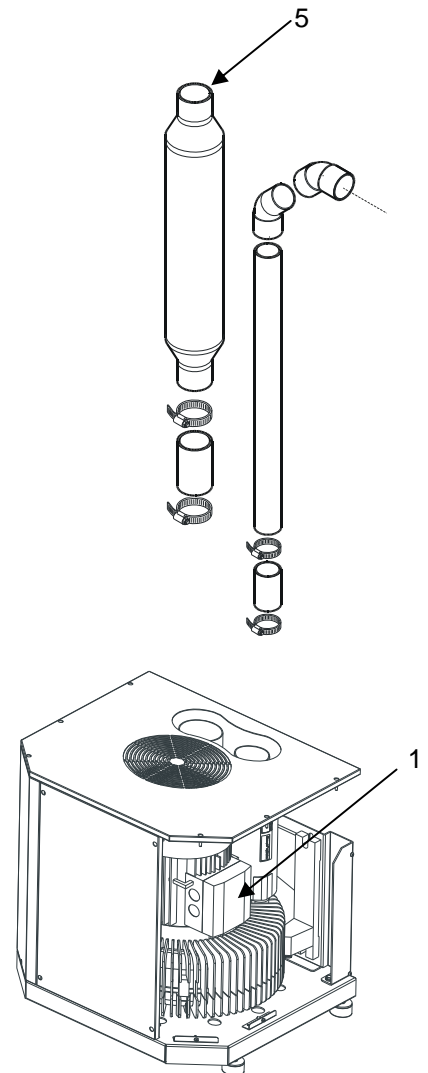
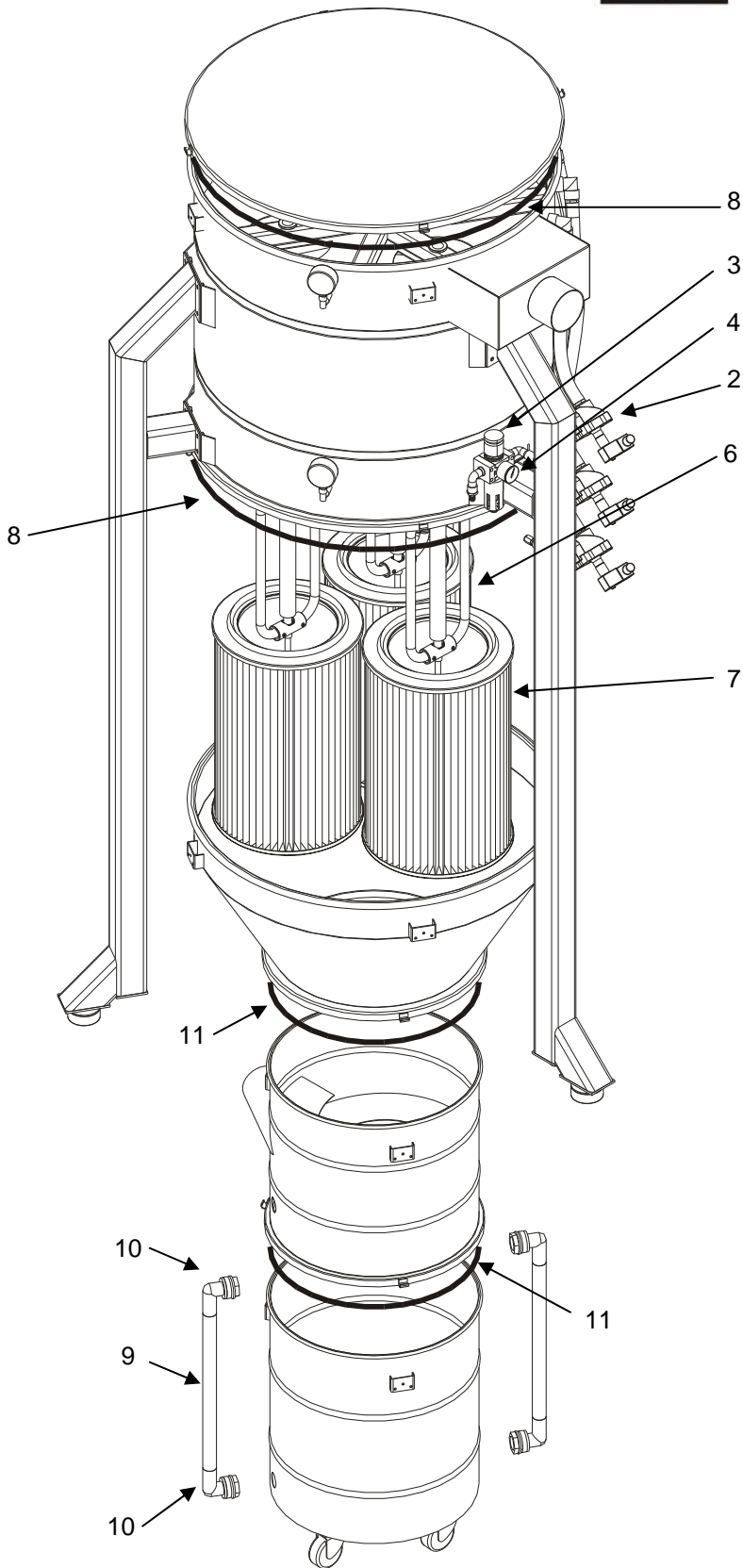

For description see table 8.1- A page 20